

VISUAL CHECKPOINT

Information use ONLY:
NOT TO BE USED FOR NAVIGATION



NORMAL VFR ARRIVAL ROUTES

Expected Arrival Clearances:

- Arriving: **(East)** From El Toro proceed to Signal Peak
Expect: Enter LEFT Traffic, RWY 20L; report UCI.
- Arriving: **(SE)** Dana Point and Laguna Beach
Expect: Proceed to Signal Peak for LEFT Traffic, RWY 20L; report UCI.
- Arriving: **(SW)** Huntington Pier
Expect: Enter RIGHT Traffic, RWY 20R; report downwind. Change is not recommended (report Fairgrounds).
- Arriving: **(WEST)** Clockwise to Chino Hills
Expect: Proceed to Mile Square Park for RIGHT Traffic, RWY 20R. Change is not recommended (report Fullerton).

MISCELLANEOUS APPROACH FREQUENCIES

ILS Localizer/DME:	I-SNA	111.75
LDA Localizer/DME:	I-OJW	108.30
AFSS:	RAL	122.45
VOT:		110.00
ASDE-X in Use:	Pilots should operate transponders with Mode C on all TWYs/RWYs	

TRAFFIC PATTERN ALTITUDES

- RWY 2L - 20R TPA:**
1056 (1000) small aircraft, 1556 (1500) turbine aircraft over 12500 lbs.
- RWY 2R - 20L TPA:**
856 (800) small single engine aircraft, 1056 (1000) twin engine aircraft.

NORMAL VFR DEPARTURE ROUTES

Departing E-NE:	El Toro Departure – " Heading 080° "
Departing SE:	Newport Departure – " Heading 150° "
Departing SW:	Mesa Departure – " Heading 220° "
Departing NW:	Orange Departure – " Heading 330° "

Squawk Code, Advisory Frequency and Altitude as assigned.

Pilots not requesting radar service beyond the surface area of the Class C airspace may state "local" when requesting their departure route. (Example: "John Wayne Clearance, Cessna N739MB, west-side parking, Mesa Local Departure.") Local radar service will be terminated upon exiting the 5 nm surface area of the Class C airspace. Pilots must then remain clear of all other regulated airspace, including the upper tier of the Class C airspace.

AVOID OVERFLIGHT OF RWY 20R/2L

VFR aircraft - to avoid overflight of RWY 20R/2L:
 RWY 20L arrival fly final at 15° angle to RWY.
 RWY 20L departures turn LEFT 15° at departure end of runway.
 To avoid overflights of RWY 2L, RWY 2R departures turn RIGHT 15° at 405 freeway.

September 2014

JOHN WAYNE AIRPORT (SNA)



LOCATION

4 nm S of the City of Santa Ana
 N33° 40.54' W117° 52.09'
 On Los Angeles Sectional, L3-L4 and Terminal Area Charts

Distances from other airports:

- 7 nm WSW of MCAS El Toro - CLOSED
- 16 nm ESE of Long Beach
- 12 nm SE of Fullerton
- 19 nm SW of Corona

Distances from NAVAIDS: (* = DME)

ELB	117.2	255°	7 nm	VOR only
SLI	115.7*	110°	11 nm	VORTAC
PDZ	112.2*	215°	22 nm	VORTAC
OCN	115.3*	303°	34 nm	VORTAC

COMMUNICATIONS FREQUENCIES

Field Elevation: 56 feet MSL

ATIS	(714) 546-2279	126.00
ASOS	(714) 424-0590	
Clearance Delivery		
VFR		121.85
IFR		118.00
John Wayne Ground*	[Unless otherwise assigned by Tower]	
EAST		120.80
WEST		132.25
John Wayne Tower*	[Operates: 0615 - 2300 LCL]	
RWY 20R/2L		126.80
RWY 20L/2R	[RWY 20L/2R CLSD when Tower CLSD]	119.90
Common Traffic Advisory Frequency (CTAF)		126.80
SOCAL Approach Frequencies*		
SW-NW		125.35
NW-NE		121.30
NE-SE		124.10
All Jets		128.10

*[NOTE: Monitor ATIS prior to contacting Clearance Delivery, Ground, Tower, or Approach Control for frequencies in use.]

LOCATED AT ALL RUNWAY HOLD POSITIONS:

- Surface painted hold position markings
- Enhanced centerline markings



IN-PAVEMENT RWY GUARD LIGHTS:

Located at TWYs D, E, L



RWY HOLD POSITION SIGN:

Hold short of RWY at TWY



ELEVATED RWY GUARD LIGHTS:

Located at ALL TWY/RWY intersections



TWY/TWY HOLDING POSITION:

HOLD HERE if instructed to by ATC



RWY HOLD BARS:

Always stop at SOLID LINE DO NOT CROSS unless instructed to do so by ATC

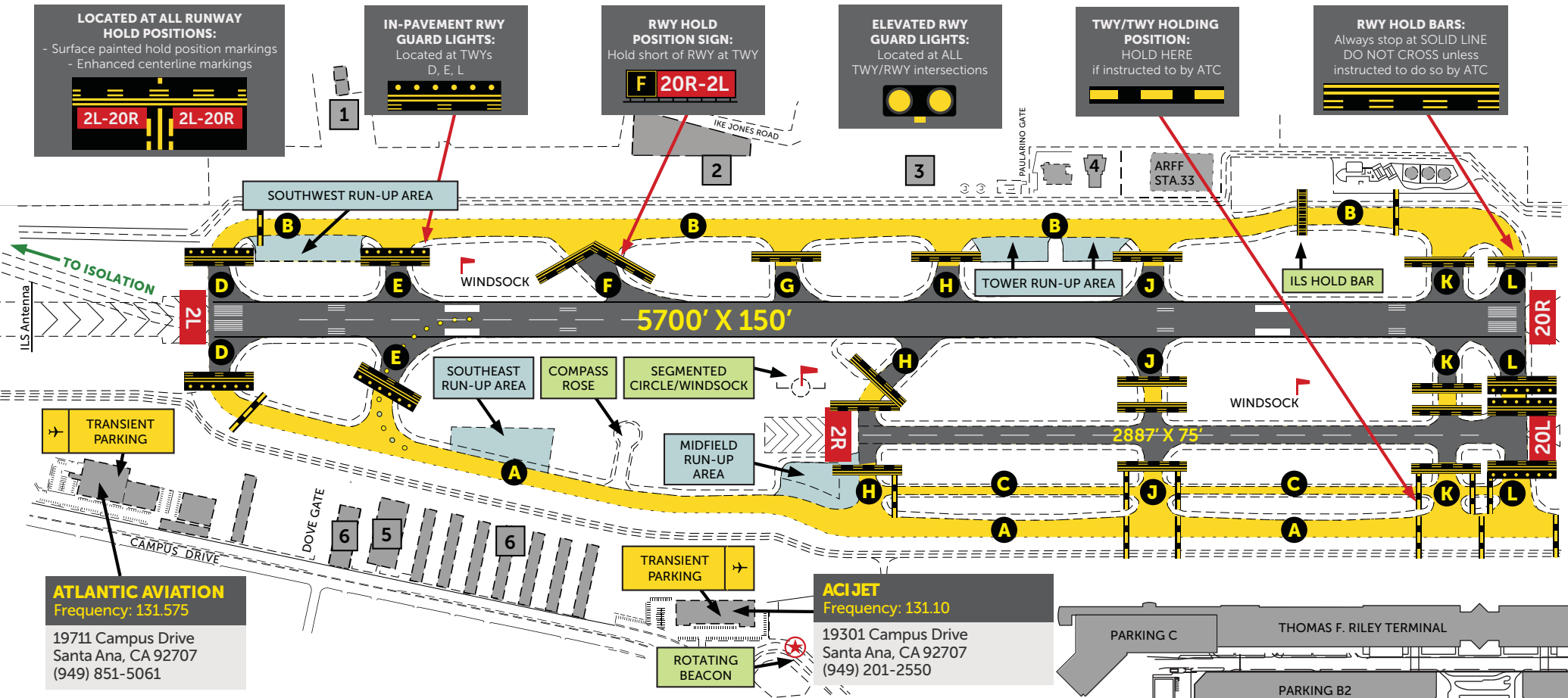

ATLANTIC AVIATION
Frequency: 131.575
19711 Campus Drive
Santa Ana, CA 92707
(949) 851-5061

ACIJET
Frequency: 131.10
19301 Campus Drive
Santa Ana, CA 92707
(949) 201-2550

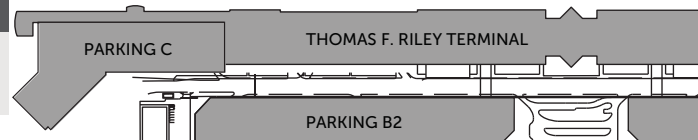

SNA TENANTS

1. Jay's Aircraft Maintenance
2. Martin Aviation/Lyon Air Museum/Western Avionics
3. ACI Jet Westside Hangars
4. FAA Control Tower
5. South Coast Associates Hangars
6. Executive Hangars

LEGEND

- Runway Environment
- Taxiway Environment
- Runway Hold Short Bars
- Run-up Areas
- In-Pavement Guard Lights
- Taxiway Lead-off Lights

HELP PREVENT RUNWAY INCURSIONS

1. "READ BACK" ALL RUNWAY HOLD SHORT INSTRUCTIONS.
2. BE VIGILANT WHEN OPERATING IN VICINITY OF TWY H, TWY C, RWY20L INTERSECTION.
3. WHEN IN DOUBT TELL CONTROLLERS "UNFAMILIAR" AND REQUEST PROGRESSIVE TAXI INSTRUCTIONS.
4. BE FAMILIAR - KNOW LAYOUT, SIGNAGE AND MARKINGS.
5. YOUR ACTIONS CAN MAKE ALL THE DIFFERENCE!